

THE DIMENSIONS SHOWN ON THIS DESIGNED DRAWING ARE FOR ILLUSTRATIVE PURPOSE
 DIMENSIONS FOR ACTUAL CARRIER TAPE MAY SLIGHTLY DIFFERENT

REV.	MODIFICATION	DATE	DRAWING	CHECKED	APPROVED
1					
2					

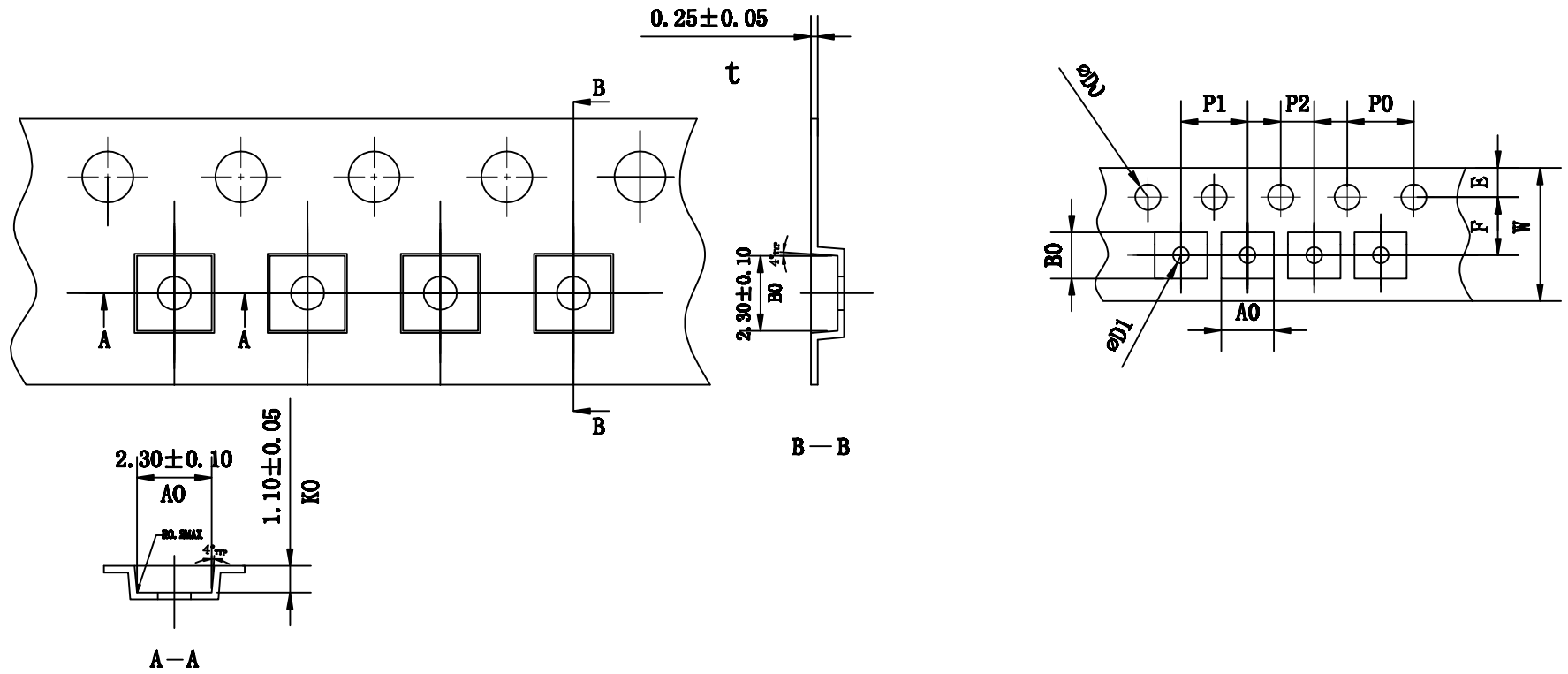

Not Marked tolerance $\pm 0.2\text{mm}$

- 1.The Maximum cumulative tolerance is $\pm 0.2\text{mm}$ for 10 sprocket hole pitch
- 2.Cambers do not exceed 1.0mm in 250mm length
- 3.All dimension follow EIA-481-D series definition
- 4.Material: ABS black conductive materials
- 5.One 22" Reel=500 Meters

ITEM	W Ⓢ	A_0 Ⓢ	A_1 Ⓢ	B_0 Ⓢ	B_1 Ⓢ	K_0 Ⓢ	K_1 Ⓢ	P_1 Ⓢ	F Ⓢ	T Ⓢ
DIM	8.00 ± 0.10	2.30 ± 0.10		2.30 ± 0.10		1.10 ± 0.05	± 0.10	4.00 ± 0.10	3.50 ± 0.05	0.25 ± 0.05
ALTERNATE										

RoHS Compliance	NAME.	CARRIER TAPE	PN	QFN2.0x2.0x0.9	SIZE	A4	DSGD		DIM TOL	Ang Tol
	Mold Ref	2.30x2.30x1.10	Customer P/N		SHEET	1/1	PROJ		X ± 0.30 X.XX ± 0.10 X $\pm 5'$	X $\pm 3'$
	MATERIAL	ABS black conductive	SCALE	1:1	REV	A/0	CHKD		X.X ± 0.20 X.XXX ± 0.05 .XX $\pm 1'$.XX $\pm 1'$
			UNIT	MM	DATE		APPD			

