

THE DIMENSIONS SHOWN ON THIS DESIGNED DRAWING ARE FOR ILLUSTRATIVE PURPOSE

DIMENSIONS FOR ACTUAL CARRIER TAPE MAY SLIGHTLY DIFFERENT

REV.	MODIFICATION	DATE	DRAWING	CHECKED	APPROVED
1					
2					

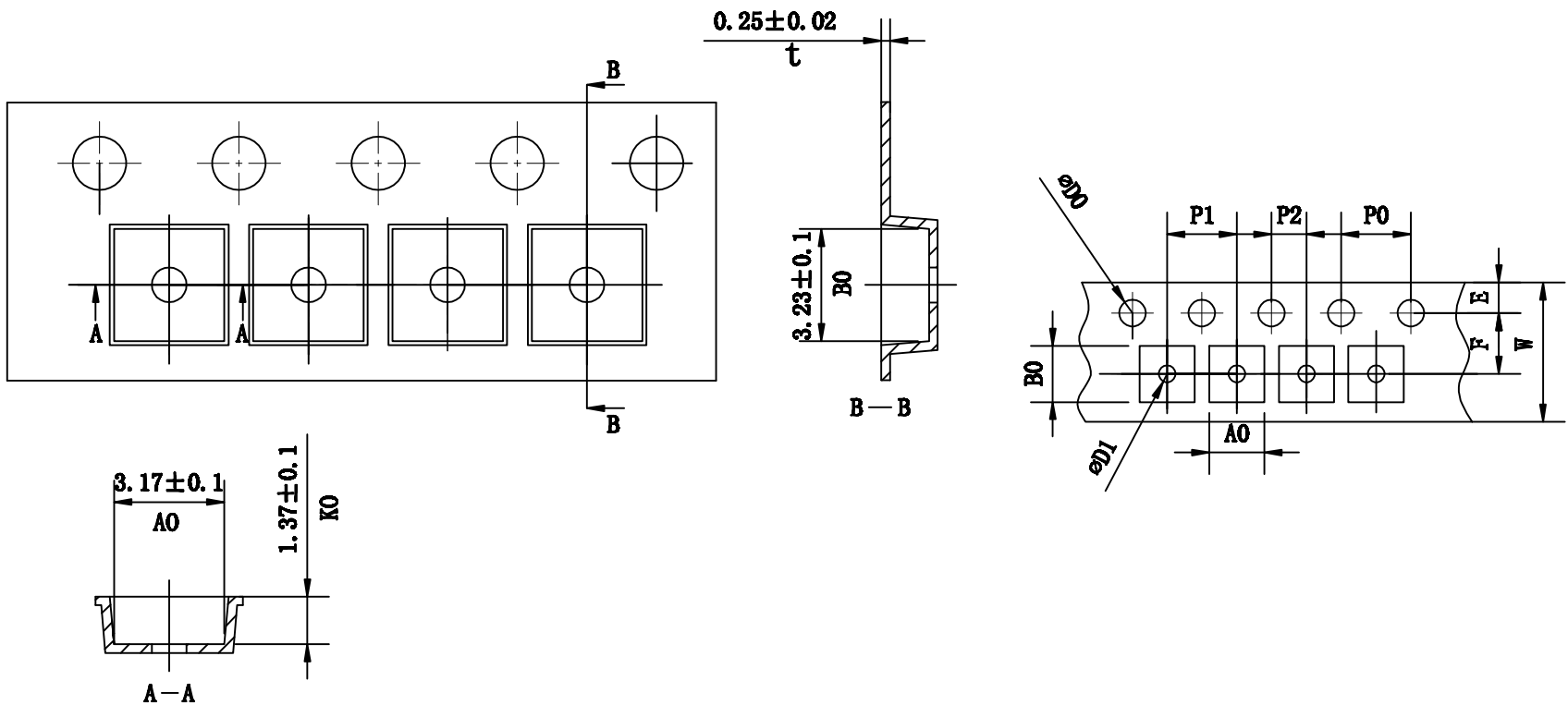

Not Marked tolerance  $\pm 0.2\text{mm}$

- 1.The Maximum cumulative tolerance is  $\pm 0.2\text{mm}$  for 10 sprocket hole pitch
- 2.Cambers do not exceed 1.0mm in 250mm length
- 3.All dimension follow EIA-481-D series definition
- 4.Material: ABS black conductive
- 5.One 22" Reel=1,000 Meters

ITEM	$W$ $\text{\textcircled{E}}$	$A_0$ $\text{\textcircled{A}}$	$A_1$ $\text{\textcircled{A}}$	$B_0$ $\text{\textcircled{A}}$	$B_1$ $\text{\textcircled{A}}$	$K_0$ $\text{\textcircled{C}}$	$K_1$ $\text{\textcircled{C}}$	$P_1$ $\text{\textcircled{A}}$	$F$ $\text{\textcircled{A}}$	$T$ $\text{\textcircled{E}}$
DIM	8.00 $\pm 0.10$	3.17 $\pm 0.10$	$\pm 0.10$	3.23 $\pm 0.10$	$\pm 0.10$	1.37 $\pm 0.10$	$\pm 0.10$	4.00 $\pm 0.10$	3.50 $\pm 0.05$	0.25 $\pm 0.05$
ALTERNATE										

RoHS Compliance	NAME.	CARRIER TAPE	Part Number	SOT25	SIZE	A4	DSGD		DIM TOL	Ang Tol
	Mold Ref	3.17*3.23*1.37	Customer P/N		SHEET	1/1	PROJ		X $\pm 0.30$ X.XX $\pm 0.10$ X $\pm 5'$	.X $\pm 3'$
	MATERIAL	ABS black conductive	SCALE	1:1	REV	A/0	CHKD		X.X $\pm 0.20$ X.XXX $\pm 0.05$ .XX $\pm 1'$	
			UNIT	MM	DATE		APPD			

