

THE DIMENSIONS SHOWN ON THIS DESIGNED DRAWING ARE FOR ILLUSTRATIVE PURPOSE
 DIMENSIONS FOR ACTUAL CARRIER TAPE MAY SLIGHTLY DIFFERENT

REV.	MODIFICATION	DATE	DRAWING	CHECKED	APPROVED
1					
2					

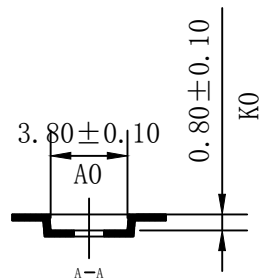
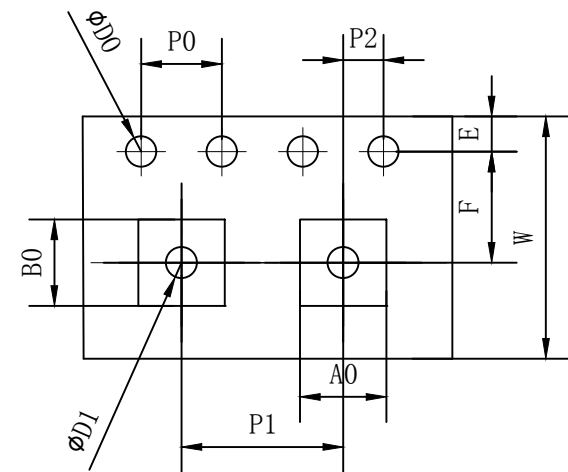
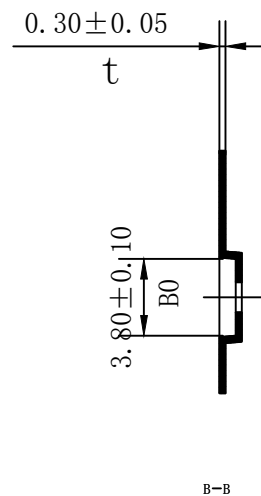
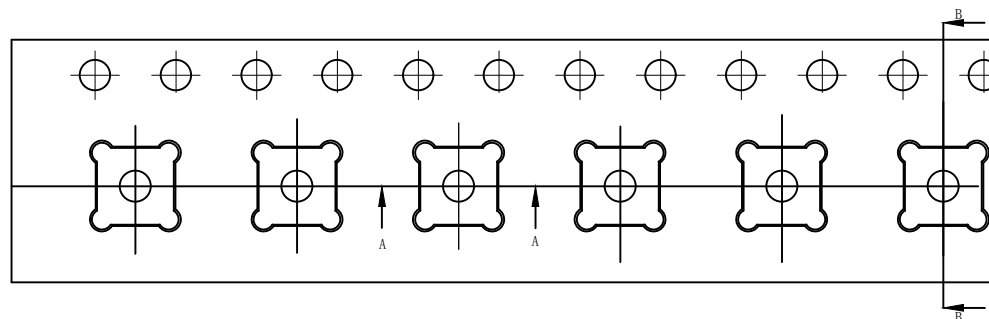

Not Marked tolerance ±0.2mm

D_0 Ⓞ	D_1 Ⓞ	P_0 Ⓞ	P_2 Ⓞ	E Ⓞ						
$1.50^{+0.10}_{-0.00}$	$1.50^{+0.10}_{-0.00}$	$4.00_{\pm 0.10}$	$2.00_{\pm 0.10}$	$1.75_{\pm 0.10}$						
ITEM	W Ⓞ	A_0 Ⓞ	A_1 Ⓞ	B_0 Ⓞ	B_1 Ⓞ	K_0 Ⓞ	K_1 Ⓞ	P_1 Ⓞ	F Ⓞ	T Ⓞ
DIM	$12.00_{\pm 0.30}$	$3.80_{\pm 0.10}$	± 0.10	$3.80_{\pm 0.10}$	± 0.10	$0.80_{\pm 0.10}$	± 0.10	$8.00_{\pm 0.10}$	$5.50_{\pm 0.10}$	$0.30_{\pm 0.05}$
ALTERNATE										

- The Maximum cumulative tolerance is ±0.2mm for 10 sprocket hole pitch
- Cambers do not exceed 1.0mm in 250mm length
- All dimension follow EIA-481-D series definition
- Material: PS black
- One 22" Reel=200 Meters

RoHS Compliance	NAME.	CARRIER TAPE	Mold Ref	QFN3.5X3.5	SIZE	A4	DSGD		DIM TOL	Ang Tol
	Mold Ref	3.80×3.80×0.80	Customer P/N		SHEET	1/1	PROJ		$X \pm 0.30$	$X.XX \pm 0.10$
	MATERIAL	PS BLACK	SCALE	1:1	REV	A/0	CHKD		$X.X \pm 0.20$	$X.XXX \pm 0.05$
			UNIT	MM	DATE		APPD			

