

THE DIMENSIONS SHOWN ON THIS DESIGNED DRAWING ARE FOR ILLUSTRATIVE PURPOSE
 DIMENSIONS FOR ACTUAL CARRIER TAPE MAY SLIGHTLY DIFFERENT

REV.	MODIFICATION	DATE	DRAWING	CHECKED	APPROVED
1					
2					

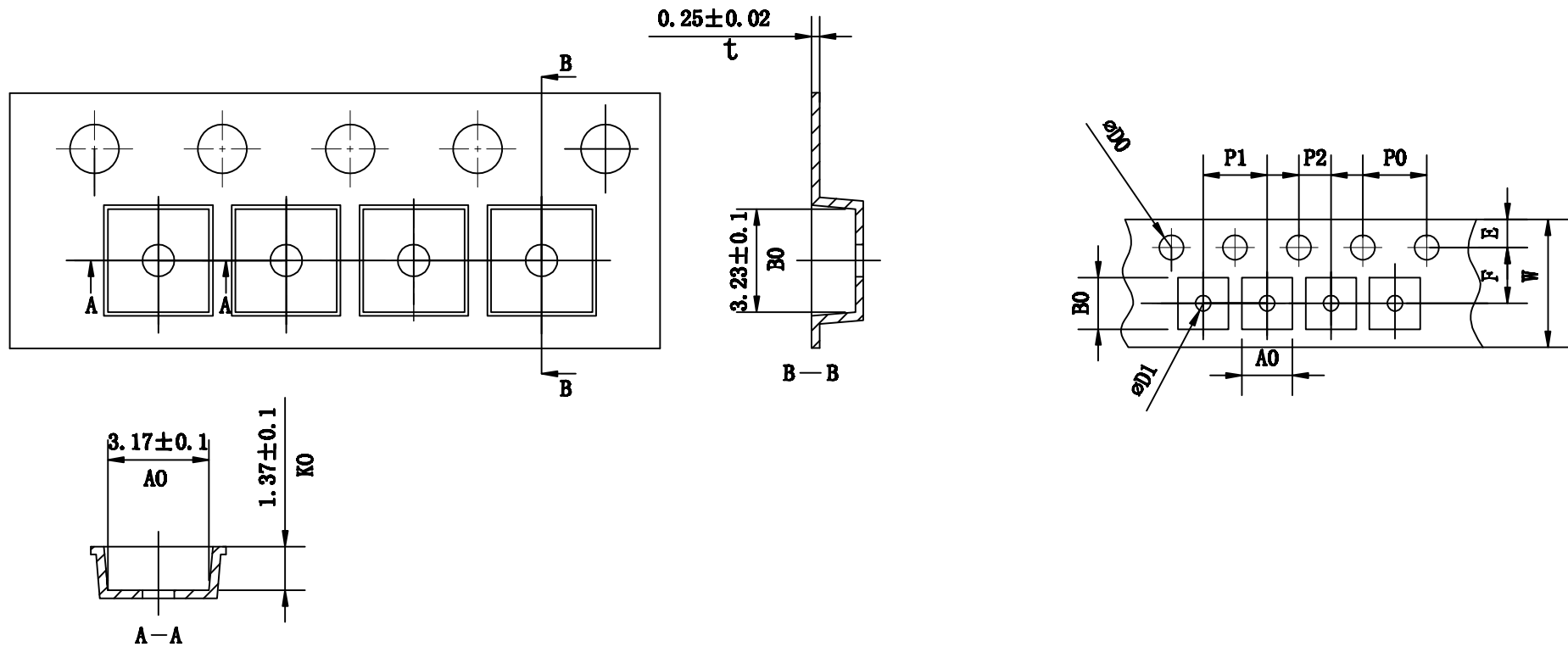

Not Marked tolerance $\pm 0.2\text{mm}$

- 1.The Maximum cumulative tolerance is $\pm 0.2\text{mm}$ for 10 sprocket hole pitch
- 2.Cambers do not exceed 1.0mm in 250mm length
- 3.All dimension follow EIA-481-D series definition
- 4.Material: ABS black conductive materials
- 5.One 22" Reel=1,000 Meters

ITEM	W $\text{\textcircled{E}}$	A $\text{\textcircled{A}}$	A $\text{\textcircled{1}}$	B $\text{\textcircled{A}}$	B $\text{\textcircled{1}}$	K $\text{\textcircled{C}}$	K $\text{\textcircled{1}}$	P $\text{\textcircled{1}}$	F $\text{\textcircled{A}}$	T $\text{\textcircled{E}}$
DIM	8.00 ± 0.10	3.17 ± 0.10		3.23 ± 0.10		1.37 ± 0.10		4.00 ± 0.10	3.50 ± 0.05	0.25 ± 0.05
ALTERNATE										

D $\text{\textcircled{0}}$	D $\text{\textcircled{1}}$	P $\text{\textcircled{0}}$	P $\text{\textcircled{2}}$	E $\text{\textcircled{A}}$
1.50 ^{+0.10} _{-0.00}	1.00 _{+0.25}	4.00 ± 0.10	2.00 ± 0.05	1.75 ± 0.10

RoHS Compliance	NAME.	CARRIER TAPE	PN	SOT23	SIZE	A4	DSGD		DIM TOL	Ang Tol
	Mold Ref	3.17x3.23x1.37	Customer P/N		SHEET	1/1	PROJ		X ± 0.30 X.XX ± 0.10 X $\pm 5^{\circ}$.X $\pm 3^{\circ}$
	MATERIAL	ABS black conductive	SCALE	1:1	REV	A/0	CHKD		X.X ± 0.20 X.XXX ± 0.05 .XX $\pm 1^{\circ}$	
			UNIT	MM	DATE		APPD			

